

ROLL TOP KERB AND CHANNEL

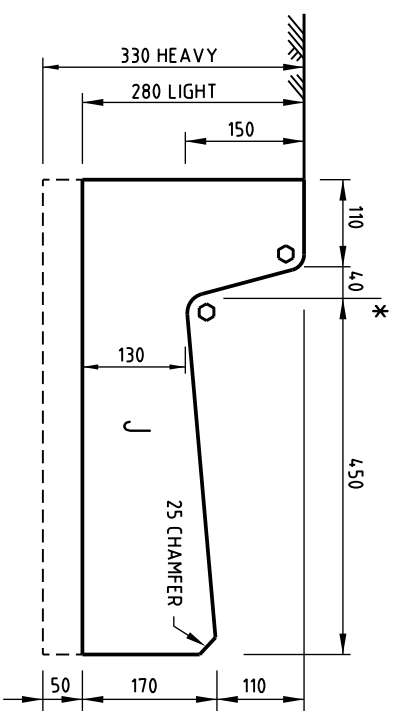

BARRIER KERB AND CHANNEL

KERB AND CHANNEL SECTIONS

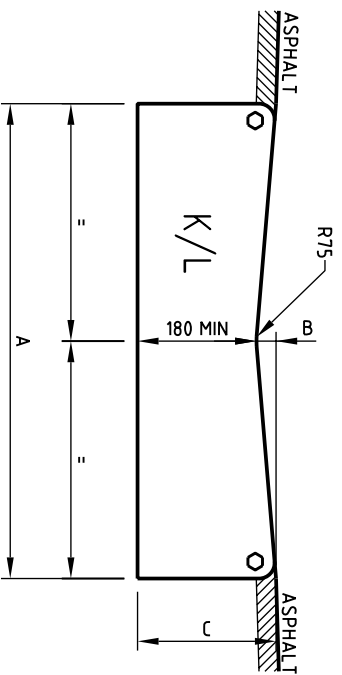

CHANNEL TYPE	DIMENSION		
	A	B	C
K	600	25	200 MIN
L	900	40	220 MIN

CHANNEL SECTION

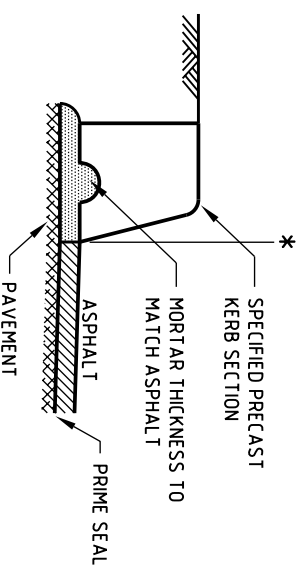

PRECAST MORTAR BED DETAIL

NOTES:

1. REFER KERB NOTES ON G.C.C. STD. DWG. No. 05-02-101.
2. DIMENSIONS ARE IN MILLIMETRES UNLESS SHOWN OTHERWISE.

LEGEND:

- * NOMINAL KERB LINE
- 20 RADIUS

THIS DRAWING IS NOT TO BE AMENDED WITHOUT REFERENCE TO STANDARDS COMMITTEE

CONTROLLED DOCUMENT

DO NOT SCALE TAKE FIGURED DIMENSIONS ONLY

STANDARD DRAWING

MICROFILMED



Gold Coast City Council
PO BOX 3924
GOLD COAST, QC 9729

No.	AMENDMENT	APPROVED	DATE	ISSUED

DRAWN BY	TECHNICAL SERVICES BRANCH	DATE

APPROVED	DATE

STANDARD DRAWING No.	ISSUE
05-02-102	2005 EDITION

KERB PROFILES
PLAN 2 OF 2

THIS DRAWING IS NOT TO BE AMENDED WITHOUT REFERENCE TO STANDARDS COMMITTEE		CONTROLLED DOCUMENT	DO NOT SCALE TAKE FIGURED DIMENSIONS ONLY
			DRAWN BY TECHNICAL SERVICES BRANCH
			PASSED 18/03/04
			APPROVED 19/03/04
AMENDMENT	APPROVED	DATE	ISSUED
No.			

STANDARD DRAWING
SUB-SURFACE DRAINAGE

MICROFILMED
 DRAWING No.
05-02-103
 ISSUE
 2005 EDITION

1. SUB-SURFACE DRAINS SHALL BE LAID A MINIMUM 300 BELOW THE SUBGRADE WHERE A HIGH WATER TABLE IS PRESENT DEEPER SUB-SURFACE DRAINS IN COMBINATION WITH MITRE DRAINS MAY BE SPECIFIED
2. SUB-SURFACE DRAINS TO BE LAID TO A MINIMUM GRADE 1 IN 100 UNLESS OTHERWISE APPROVED. WHERE ROAD GRADING ALLOWS, THE SPACE BETWEEN THE INVERT OF THE SERVICE CONDUIT AND THE OVERTOP OF THE SUB-SURFACE DRAIN SHALL BE 50
3. SELECTED FILTER MATERIAL TO BE CLEAN AGGREGATE GRADED 10 TO 20
4. FLUSHING POINTS ARE TO BE CONSTRUCTED AT THE HEAD OF LINES WITH CLEANING JUNCTIONS AT MAXIMUM 50m CENTRES IMMEDIATELY BEHIND KERB.
5. SUB-SURFACE DRAINS SHOULD GENERALLY OUTLET AT STORMWATER GULLY PITS AT A LEVEL ABOVE THE TOP HALF OF THE OUTLET PIPE (REFER TO DETAIL)
6. PIPES TO BE SLOTTED POLYETHYLENE CLASS 400 TO AS2439 AND FITTINGS TO BE uPVC SEWER FITTINGS CLASS SH TO AS 1260
7. FOR MITRE DRAIN DETAILS REFER G.C.C.C. STD. DWG. No. 05-02-104.
8. DIMENSIONS ARE IN MILLIMETRES UNLESS SHOWN OTHERWISE.

NOTES:

TYPICAL SECTION

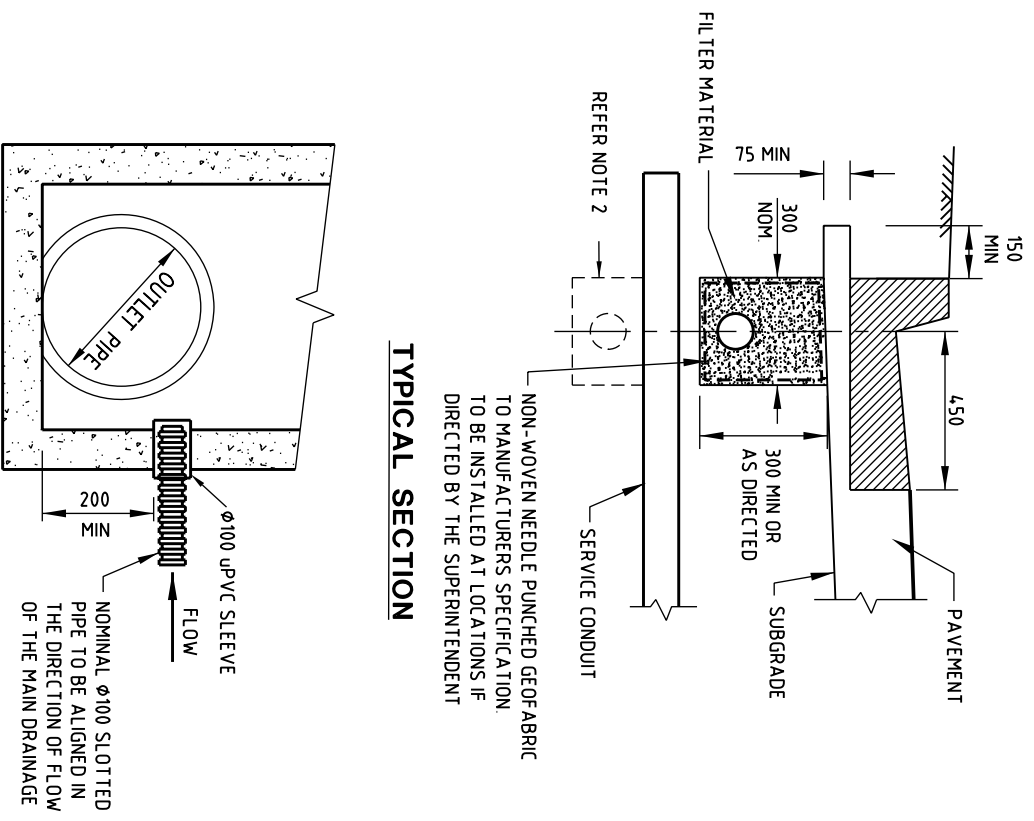

DRAINAGE OUTLET POINT AT GULLY PIT

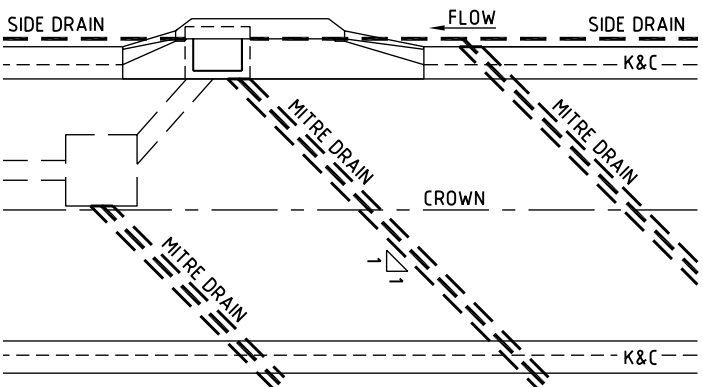

PLAN

TYPICAL MITRE DRAIN LOCATIONS

SIDE DRAIN ON ONE SIDE ONLY

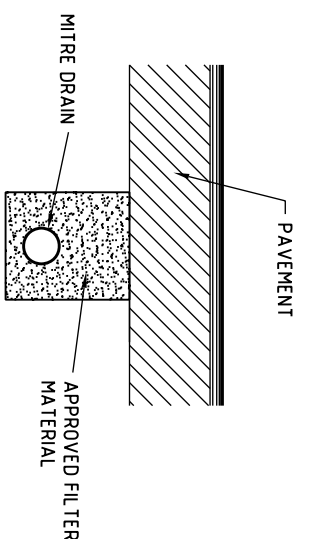

TYPICAL SECTION

NOTES:

- 1 THE PROVISION AND LOCATION OF MITRE DRAINS WILL BE DETERMINED ON SITE BY THE SUPERINTENDENT WHERE SIDE DRAINS ARE PROVIDED ON BOTH SIDES OF THE ROADWAY MITRE DRAINS MEET AT THE CROWN WHERE A SIDE DRAIN IS PROVIDED ON ONE SIDE ONLY MITRE DRAINS ARE TO BE CONSTRUCTED DIAGONALLY THROUGH THE FULL WIDTH OF THE SUBGRADE
- 2 PIPES TO BE SLOTTED POLYETHYLENE CLASS 400 TO AS2439 AND FITTINGS TO BE SEWER FITTINGS CLASS SH TO AS 1260
- 3 SELECTED FILTER MATERIAL TO BE CLEAN AGGREGATE GRADED 10 TO 20.
- 4 MITRE DRAINS TO BE LAID AT A MINIMUM GRADE OF 1 IN 200.
- 5 MITRE DRAINS DISCHARGING TO STORMWATER GULLY PITS/MANHOLE'S SHOULD GENERALLY ENTER THE PIT/MANHOLE AT A LEVEL ABOVE THE TOP HALF OF THE OUTLET PIPE REFER TO DETAIL ON G.C.C.C STD DWG No 05-02-103
- 6 DIMENSIONS ARE IN MILLIMETRES UNLESS SHOWN OTHERWISE.

THIS DRAWING IS NOT TO BE AMENDED WITHOUT REFERENCE TO STANDARDS COMMITTEE

CONTROLLED DOCUMENT

DO NOT SCALE TAKE FIGURED DIMENSIONS ONLY

STANDARD DRAWING

MICROFILMED

Gold Coast City Council
 GOLD COAST CITY COUNCIL
 PO BOX 5024
 GOLD COAST MC 9729

No.	AMENDMENT	APPROVED	DATE	ISSUED

DRAWN BY	TECHNICAL SERVICES BRANCH
PASSED	18/03/04
APPROVED	19/03/04

MITRE DRAIN DETAILS

STANDARD DRAWING No.
05-02-104
 ISSUE
 2005 EDITION

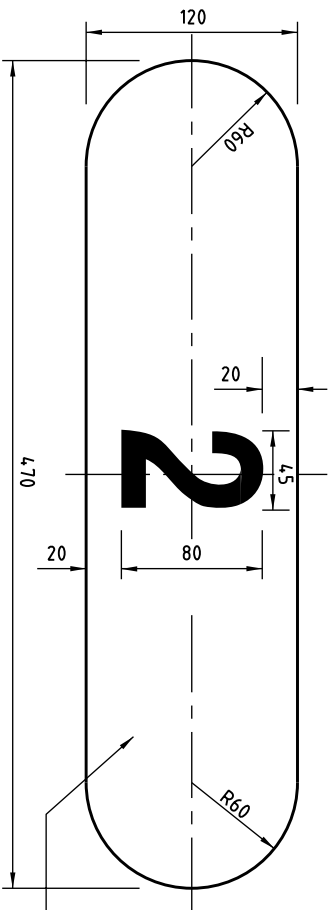

ONE CHARACTER

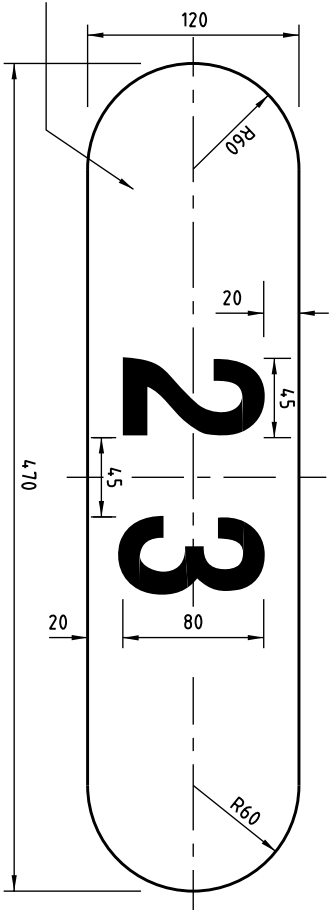

TWO CHARACTERS

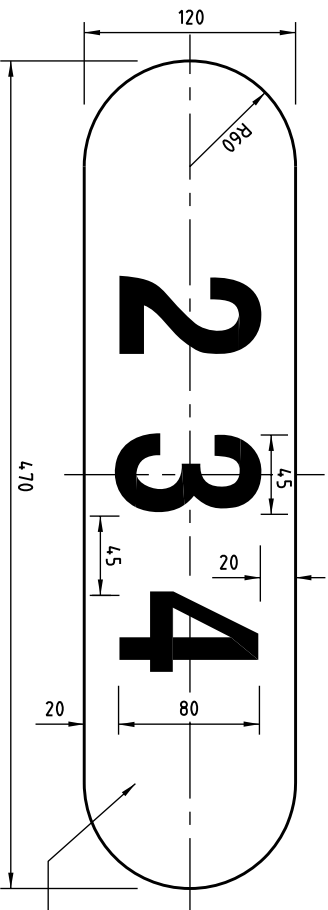

THREE CHARACTERS

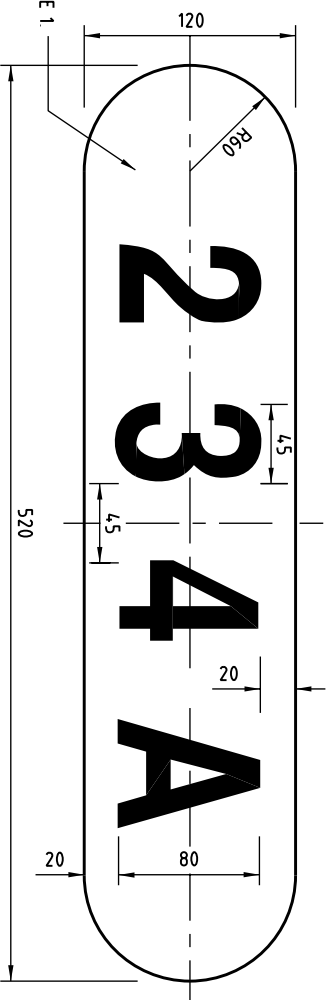

FOUR CHARACTERS

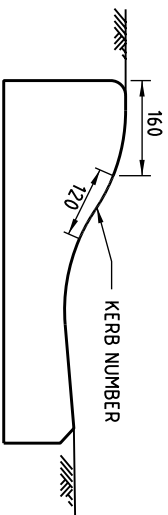

ROLL TOP KERB & CHANNEL

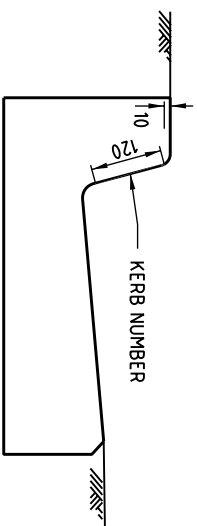

BARRIER KERB & CHANNEL

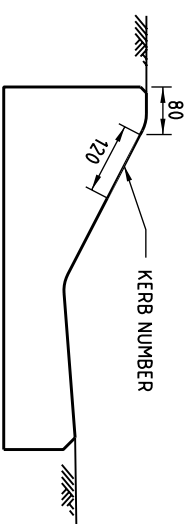

LAYBACK KERB & CHANNEL

KERB NUMBERING LOCATIONS

- NOTES.**
1. PAINT FOR KERB NUMBERING SHALL COMPLY WITH THE FOLLOWING:
 BACKGROUND PAINT - COLOUR: Y14, GOLDEN YELLOW IN ACCORDANCE WITH AS 2700
 - TYPE: WATERBORNE PAINT IN ACCORDANCE WITH AS4049.3
 DROP ON BEADS - GLASS BEADS TO BE APPLIED TO BACKGROUND PAINT IN ACCORDANCE WITH AS2009
 CHARACTER PAINT - COLOUR: NO LIGHTER THAN B64, CHARCOAL IN ACCORDANCE WITH AS2700.
 - TYPE: TWO PART HIGH BUILD RECOATABLE EPOXY.
 2. TEMPLATE CHARACTERS ARE TO COMPLY WITH AS 1744 (SERIES 'D').
 3. THE KERB NUMBERS ARE TO BE PAINTED ON THE KERB AT THE APPROACH SIDE OF DRIVEWAYS OR, WHERE THERE IS NO DRIVEWAY, AT THE CENTRE OF THE PROJECTION OF THE LOT BOUNDARIES.
 4. ALL DIMENSIONS ARE IN MILLIMETRES UNLESS SHOWN OTHERWISE.



Gold Coast City Council
 GOLD COAST CITY COUNCIL
 PO BOX 3042
 GOLD COAST, QC 9729

No.	AMENDMENT	APPROVED	DATE	ISSUED

THIS DRAWING IS NOT TO BE AMENDED WITHOUT REFERENCE TO STANDARDS COMMITTEE

CONTROLLED DOCUMENT

DO NOT SCALE TAKE FIGURED DIMENSIONS ONLY

STANDARD DRAWING

MICROFILMED

DRAWN BY
 TECHNICAL SERVICES BRANCH
 18/03/04

APPROVED
 19/03/04

KERB NUMBERING

STANDARD No. 05-02-105

ISSUE 2005 EDITION