



Keeping poultry

If you keep poultry, it's your responsibility to ensure they do not have a negative impact on your neighbours and the environment.

Keeping poultry in your backyard has lots of benefits and, done properly, will reduce kitchen and food waste and reward you and your garden. Our local laws limit the number of animals that can be kept depending on the size of a property. Keeping roosters in residential areas is prohibited.

How must I keep them?

Poultry must be kept without causing a nuisance:

- Poultry must be contained within an appropriate enclosure on your property.
- The enclosure must be cleaned thoroughly at least once per week.
- Food must be stored within a vermin-proof container.
- Poultry noise must not cause a nuisance.

The enclosure must be located:

- not less than 1 metre from the property boundary
- at the rear of, and behind, any residence
- not within 10 metres of any residence, food storage or preparation area.

Roosters, peacocks, ostriches and emus

Less than 4000m² Prohibited
 4000m² or more Minimum standards

Geese, ducks, and turkeys

Less than 4000m² Prohibited
 4000m² or more One per 300m²

Domestic hens

600m² or less Prohibited
 More than 600m² One per 150m²

ALL PET OWNERS MUST COMPLY WITH MINIMUM STANDARDS FOR KEEPING AN ANIMAL ON THEIR PROPERTY. ENFORCEMENT ACTION MAY BE TAKEN FOR THOSE NOT DOING THE RIGHT THING.



Roosters

Avoid roosters – they're not needed to produce eggs and are not allowed on smaller properties (less than 4000m²). The noise of a rooster crowing at unsocial hours won't be popular with your neighbours! They also tend to make chickens broody (sit on their eggs to hatch chicks), which will reduce the number of eggs they lay.

Protect your poultry

Protecting poultry requires planning as well as regular maintenance and monitoring to ensure that they are kept safe. Ensure you:

- provide a sturdy and safe living place for poultry
- lock up the poultry (especially at night)
- provide predator barriers
- deter predators.

Find out which predators are common in your area (for example, foxes, feral cats, domestic dogs, wild dogs, hawks or snakes) and take this into consideration when designing and building your poultry run.

Foxes can be found throughout the Gold Coast, including suburban and semi-rural areas. An increase in the number of households on the Gold Coast keeping backyard poultry, also increases the likelihood of these unwanted predators. If you are aware of fox activity in your area, protect your poultry by erecting a fox-proof enclosure.

Foxes are quick and efficient killers and will opportunistically kill and take free-ranging poultry, even during the day. It is not recommended to free-range poultry without the adequate protection of a secure pen and run, preventing predators from getting in.

For more information

P 07 5667 5990

W cityofgoldcoast.com.au/animals

Fox proof enclosure

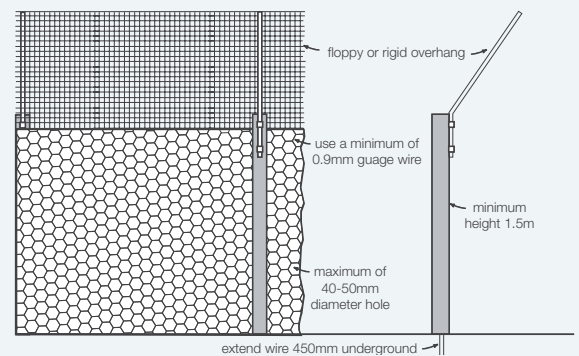

Foxes are excellent jumpers and climbers. Fences should be at least 1.5 metres high, with an outward facing overhang to prevent foxes scaling the fence. These overhangs can be flexible or rigid and can incorporate electric wires as added deterrents. In smaller pens, a complete wire netting roof is also an option.

Foxes are also excellent diggers. Wire netting should be either buried at least 450mm underground or attached to a concrete or wooden floor.

Runs and yards need to be constructed with a strong material (0.9mm gauge) that cannot be chewed and 40–50mm diameter hexagonal wire netting stops foxes pushing through the fence.

Remove anything that foxes could use to hide when sneaking up on poultry. This includes tall grass, junk, machinery and timber.