

PLAN

NOTES:

1. CONCRETE FOOTINGS TO BE GRADE N25 (AS 1379)
2. GALVANISED STEEL TUBE TO BE IN ACCORDANCE WITH AS 1163
3. EACH UNIT TO BE FORMED FROM ONE 6.5m LENGTH OF TUBE BY ROLL FORMING ONLY
4. ALL UNITS TO BE GALVANISED AFTER FABRICATION
5. UNITS TO BE FINISHED WITH TWO COATS OF TWO PACK 125 MICRON MINIMUM TOTAL THICKNESS (eg WATTYL PARACRYL OR EQUIVALENT PROCESS). COLOUR TO BE YELLOW
6. REFLECTIVE TAPE TO BE CLASS 2 (AS 1906.1)
7. RAILS TO BE LOCATED IN ACCORDANCE WITH AUSTRROADS "GUIDE TO TRAFFIC ENGINEERING PRACTICE PART 14 BICYCLES"
8. DIMENSIONS ARE IN MILLIMETRES UNLESS SHOWN OTHERWISE

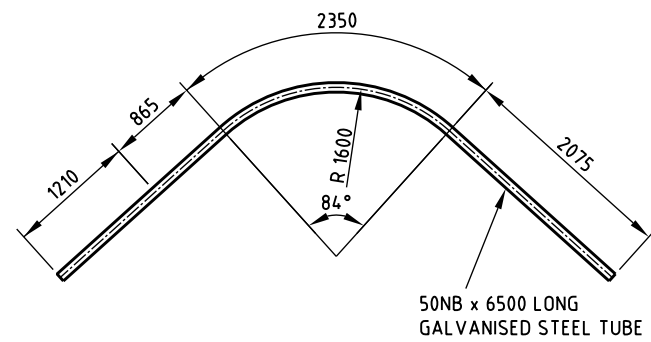

PLAN - BEND 1

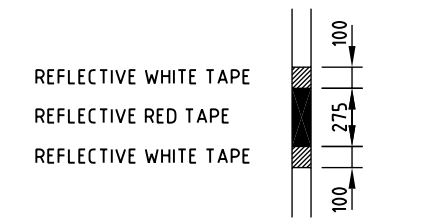

REFLECTIVE TAPE DETAIL

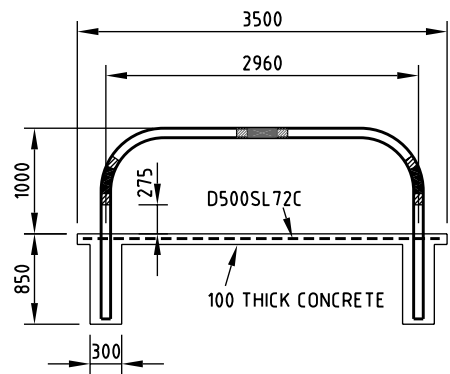

ELEVATION

INSTALLATION DETAILS

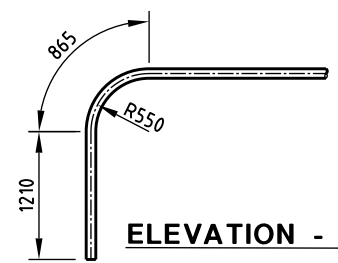

ELEVATION - BEND 2

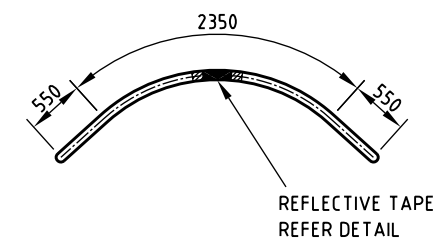

PLAN - AFTER BEND 3

BENDING DETAIL



THIS DRAWING IS NOT TO BE AMENDED WITHOUT REFERENCE TO STANDARDS COMMITTEE				
CONTROLLED DOCUMENT				
DO NOT SCALE TAKE FIGURED DIMENSIONS ONLY				
DRAWN BY TECHNICAL SERVICES BRANCH				
PASSED <i>[Signature]</i> 18/03/04				
APPROVED <i>[Signature]</i> 19/03/04				
No.	AMENDMENT	APPROVED	DATE	ISSUED

STANDARD DRAWING	
BICYCLE PATH ENTRANCE DEFLECTION RAIL	

MICROFILMED
STANDARD DRAWING No. 05-02-402
ISSUE 2005 EDITION