

COMMON TRENCHING			
TRENCH WIDTH W	NOM. DIA d		TYPE 8
	POTABLE	RECYCLED	
850	63 x 63		A
	63 x 100		B
	90 x 100		C
	100 x 100		D
	90 x 150		E
	150 x 100		F
	150 x 150		G

COMMON TRENCHING FOR LARGER MAIN SIZES SHALL BE DETERMINED BY COUNCIL. ADDITIONAL VERGE AND 500 BETWEEN MAINS WIDTH SHALL BE PROVIDED.

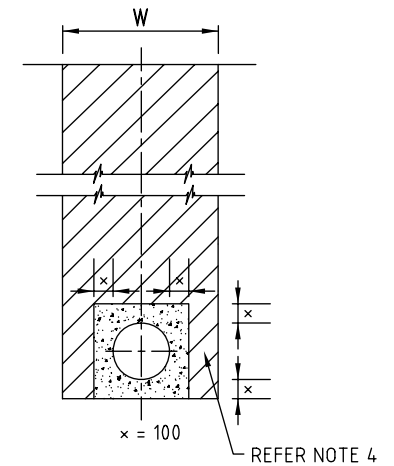

**NOTES:**

- FOR COMMON TRENCH BEDDING AND BACK FILL REQUIREMENTS REFER COUNCILS STANDARD SPECIFICATION SS2.1 AND SS2.2
- CONCRETE ENCASEMENT & BULKHEADS SHALL BE INDEPENDENT FROM ADJOINING MAIN USE 12 COMPRESSIBLE MEMBRANE.
- PROVIDE APPROPRIATE MARKER TAPE FOR ALL WATER MAINS.
- FOR GENERAL CONSTRUCTION DETAILS REFER TO GCCC STD DWG No. 08-06-101.
- PIPE ENVELOPER DETAILS SHALL BE GENERALLY BE IN ACCORDANCE WITH WSAA STD DWG No. WAT - 1214. ANNULUS GROUT 20 PARTS SAND, 2 PARTS LIME AND ONE PART CEMENT PER VOLUME.
- DIMENSIONS ARE IN MILLIMETRES UNLESS SHOWN OTHERWISE.

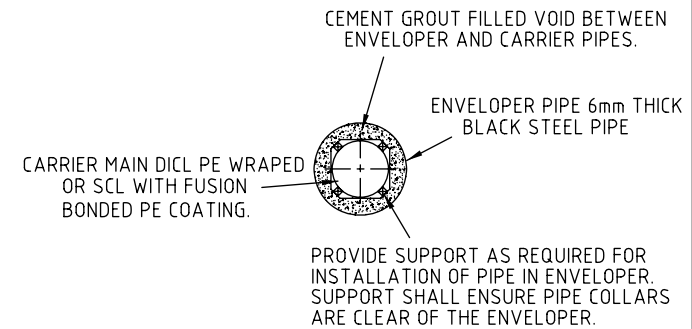
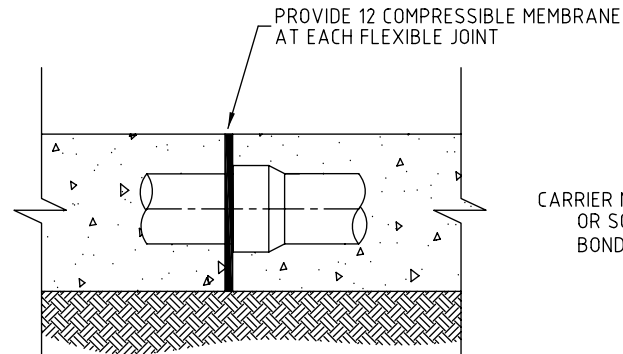

**Gold Coast City Council**  
GOLD COAST CITY COUNCIL  
PO BOX 5042  
GOLD COAST MC 9729

THIS DRAWING IS NOT TO BE AMENDED WITHOUT REFERENCE TO STANDARDS COMMITTEE					CONTROLLED DOCUMENT
No.	AMENDMENT	APPROVED	DATE	ISSUED	

DO NOT SCALE TAKE FIGURED DIMENSIONS ONLY	
DRAWN BY	G.C.W
PASSED	D. HAYMAN 08/07/08
APPROVED	R. WENT 08/07/08

**STANDARD DRAWING**  
**DUAL WATER RETICULATION SYSTEM  
TRENCH & BEDDING DETAILS**

MICROFILMED
STANDARD DRAWING No. 08-06-103
ISSUE 2008 EDITION